

## Special Parts

### Flameproof protective covers

Types 40, 49, 50, 55 are available in asbestos-free design approved by the Classification Society.

These accessories protect the rubber compensator against the effects of flames up to 800°C for a period of 30 minutes. WILLBRANDT compensators together with their flameproof protective covers satisfy the requirements of the Classification Society for use on ships, for fire extinguishing piping in operational buildings or in pressure booster plants.

#### Installation information:

The compensators are installed in the usual manner. The protective covers are fitted after installation and cover both the compensator and adjacent pipe flange. Operation of WILLBRANDT compensators is not hindered as the cover extends to the pipe, the full movement of the compensator can be absorbed. Special cover and restraint sizes are available on request.



Diagram shows open condition.

### Deflector sleeve

This should always be used for highly abrasive media or if strong turbulence is to be avoided. The deflector sleeve is made in conical form with edge flange/holed flange, so that the expansion capabilities of the compensator are least affected.

The deflector sleeve length depends on the length of the compensator and the movement to be absorbed (standard value: compensator length - 15 mm corresponds to the deflector sleeve length).

#### Installation information:

Gaskets must be fitted. Gap between the buildings should be arranged according to the deflector.

#### Attention:

In the case of axial expansion in excess of -15mm, the mating flange inside diameter must be taken into account and the deflector sleeve diameter checked. With lateral expansion, the deflector sleeve diameter reduces by twice the lateral movement to be absorbed (standard design for lat. +/-5mm).

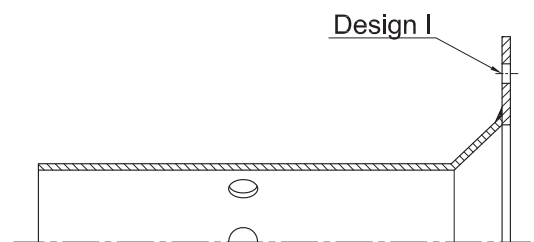

Design I with flange hole pattern

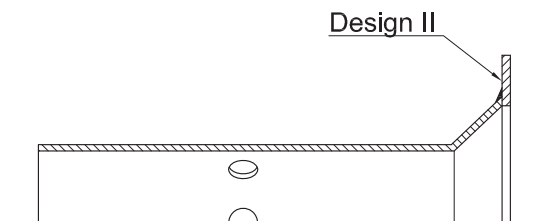

Design II with collar